

# Product Information for radoppio Management System

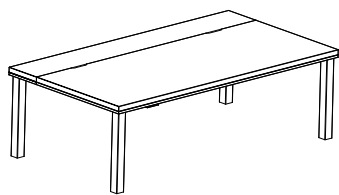

## Product Characteristics

- High-quality management system for ergonomic conditions in the management area
- Electromotive height adjustment: 680 – 1,180 mm
- Desk top substrate made of MDF, through-dyed in black, veneer or lacquered, with 2 cutouts for cables
- Technology sideboard elegantly integrates a computer, printer, etc.
- Desk depths: 1,200 mm for meetings right in the office (sitting or standing)
- Desk widths: 2,000 / 2,200 / 2,400 mm
- Desk top thickness: 60 mm, with a groove all around
- High-quality surfaces in real wood and lacquer
- Handcrafted details

## Frame

- All ophelis desk systems meet the requirements of the new EN 527 standard for office desks
- 4-leg electromotive: Round or square tubular legs
- Leg base exterior: chrome, glossy; interior column: black or exterior and interior column black
- Round tubing: 70 mm diameter
- Square tubing: 70 x 70 mm

## Height adjustment

- Sit-Stand Desks:
  - Electromotive height adjustment: 680 – 1,180 mm
- Memory control: offers the ability to save settings for four users for each of 3 desk heights and select on of the saved heights at the push of a button, height display at the push of a button

## Electrification

- Clip-on vertical steel cable channel, black and chrome + vertical cable chain
- Convenient Electrification: rear part of table top is fixed, front part can be opened as a sliding panel to provide convenient access to the horizontal cable channel across the entire width of the desk, plus cutouts for electrical cables
- Convenient Electrification for technology sideboard: Vertical steel cable channel integrated in the leg, cover for cable guide and desk leg with moveable steel panel in the same colour as the frame. Steel box to cover floor outlet, desk leg and the slack from the cables, with recessed triple system unit (fit with components as needed)

## Layout of the radoppio Management System

- 1 adjustable leg with height adjustment screw
- 2 tubular leg
- 3 Table top frame
- 4 horizontal cable channel
- 5 desk top
- 6 memory control element
- 7 lock button

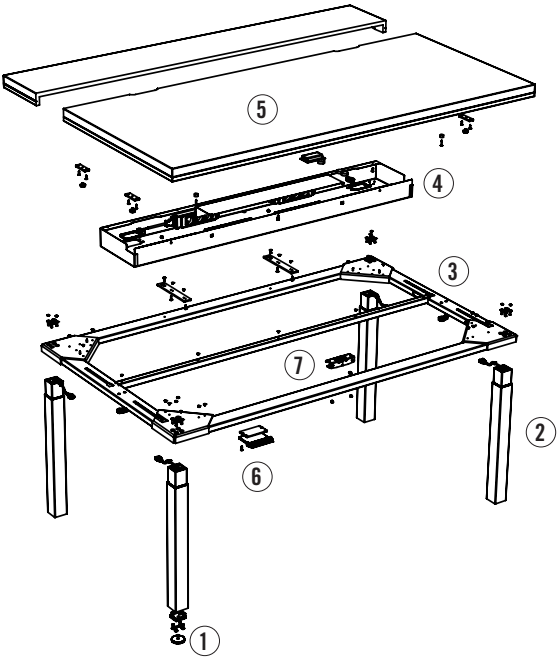

## Technology Sideboard

Dimensions (HxWxD) 538 x 1,600 x 603.5 mm			
8 height units - utensil drawer + drawer 2 HU + drawer 6 HU		8 height units - utensil drawer + drawer 2 HU + drawer 3 HU + drawer 3 HU	
Container outside, shelf in the centre with 2 drawers, shelf with hinged door inside	Container outside, shelf in the centre with 1 drawer and 1 printer shelf, shelf with hinged door inside	Container outside, shelf in the centre with 2 drawers, shelf with hinged door inside	Container outside, shelf in the centre with 1 drawer and 1 printer shelf, shelf with hinged door inside

## Notes:

- The front desk leg is inserted into the sideboard on the side with the hinged door.
- Ventilation outlet along the entire width of the rear panel (with brush to keep out dust and cable mounting)
- Milled-out portions between shelves for cable management